

KOMATSU®

PC205-10M0

CE

HYDRAULIC EXCAVATOR



Photos may include optional equipment.

OPERATING WEIGHT: 20300 - 20900 kg

GROSS HP: 110 kW 148 HP/2000 min⁻¹





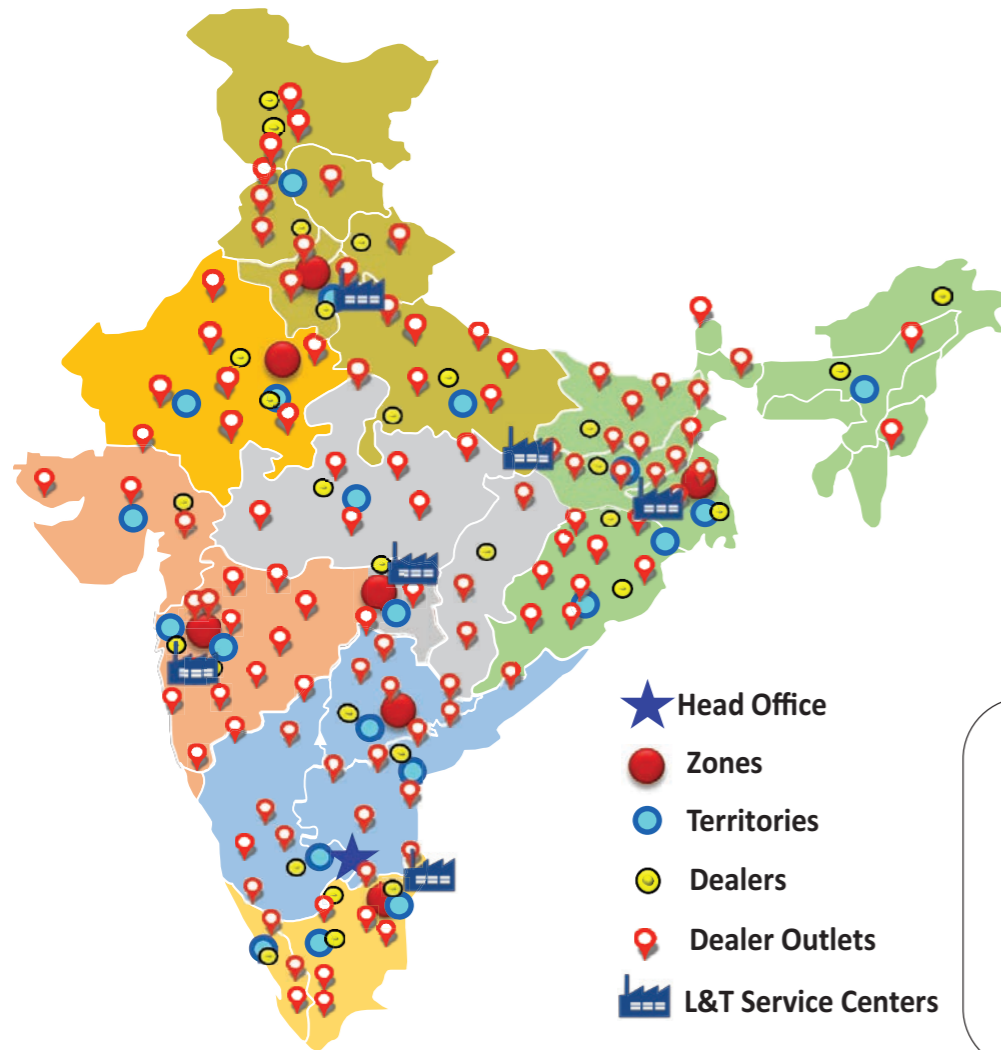

BUCKET CAPACITY: 0.85 / 1.00 m³

NET HP: 103 kW 138 HP/2000 min⁻¹

PC205-10M0

 **L&T CMB NATIONWIDE SALES & AFTER SALES SUPPORT NETWORK**



-  **Head Office**
-  **Zones**
-  **Territories**
-  **Dealers**
-  **Dealer Outlets**
-  **L&T Service Centers**



Product improvement is a continuous process. Specifications given in this publication are therefore subject to change without notice. Photographs depicted may be of optional equipment

www.komatsuindia.in

Printed on 05-2022

KOMATSU®



Marketed & Serviced by:

L&T Construction & Mining Machinery

Larsen & Toubro Limited

1st Floor Lakshminarayan Complex, 10/1 Palace Road, Bengaluru- 560 052

Tel: 080 40401700 / 900

E-mail: ceb@larsentoubro.com www.lntcmb.com

Zonal Offices:

Delhi (011) 40819500
Nagpur (0712) 6606441/2260025
Jaipur (0141) 4385900

Kolkata (033) 44002433/22831442
Hyderabad (040) 47575064

Pune (020) 48544259
Chennai (044) 40706864

CIN: L99999MH1946PLC004768

Materials and specifications are subject to change without notice.
KOMATSU is a trademark of Komatsu Ltd. Japan.

WALK-AROUND

High Performance with Low Initial Cost

Ideal for Excavation & Handling operation



Lower Fuel Consumption

- **Reduction of fuel consumption** (Similar to PC210-10M0)
- **Reduction of hydraulic piping loss**

Lower Maintenance Cost

- **Less maintenance time with new features**
- **System to detect and prevent failure of major components**
- **Monitor panel displays a wide range of maintenance information for quick action**

Higher Durability

- **Enhanced work equipment**
- **Improved swing circle rigidity**

Safety & Comfort

- **Large comfortable cab**
- **Rear view monitor system (Optional)**

Information & Communication Technology (ICT) & KOMTRAX

- **Large high resolution Liquid Crystal Display (LCD) monitor**
- **Equipment Management Monitoring System**
- **KOMTRAX**

LOWER FUEL CONSUMPTION

PC205-10M0

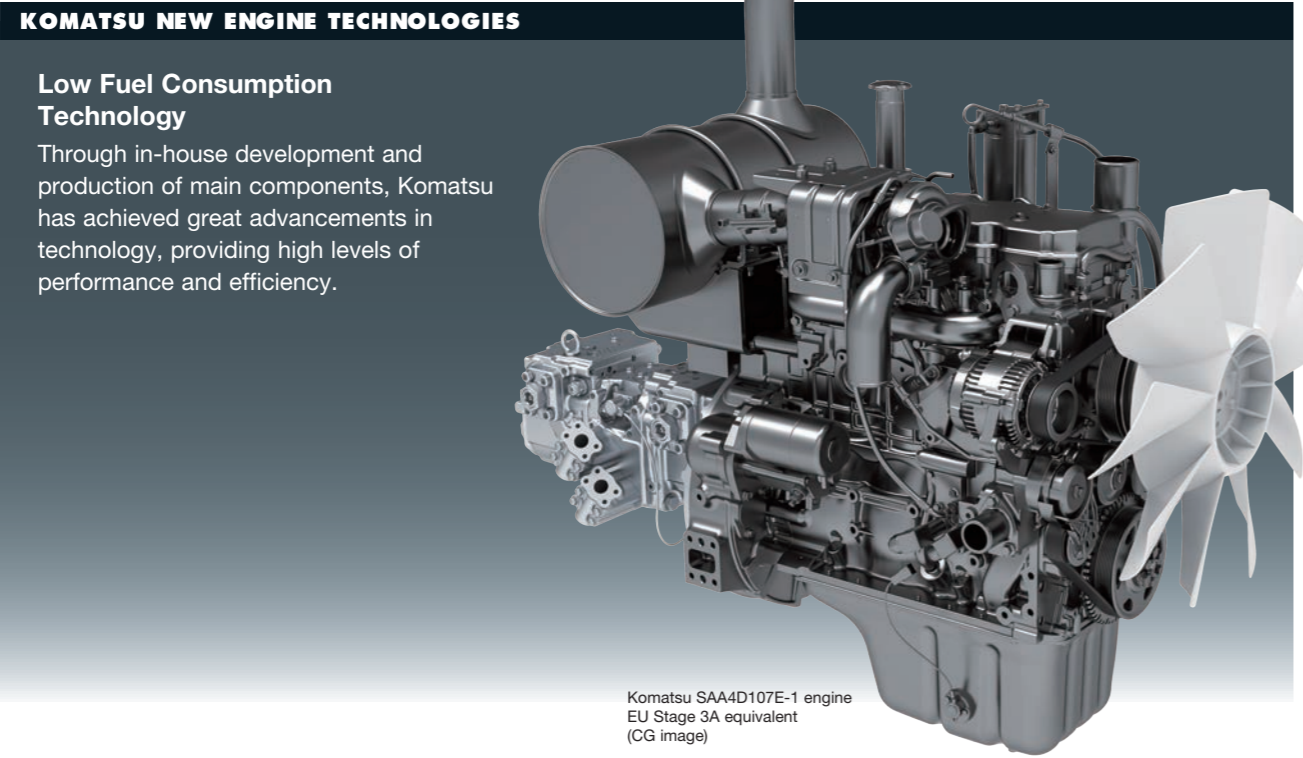

Komatsu SAA4D107E-1 engine
EU Stage 3A equivalent
(CG image)

KOMATSU NEW ENGINE TECHNOLOGIES

Low Fuel Consumption Technology

Through in-house development and production of main components, Komatsu has achieved great advancements in technology, providing high levels of performance and efficiency.

New 4-cylinder engine

Equipped with new 4-cylinder engine to reduce fuel consumption. In particular, the fuel efficiency during idling is improved significantly. It is optimal for general construction sites.

Reduction of hydraulic pressure loss

The internal shape of the control valves, piping diameter and fitting shape have been thoroughly revised. With this improvement, hydraulic loss is reduced more than ever. It contributes to low fuel consumption.

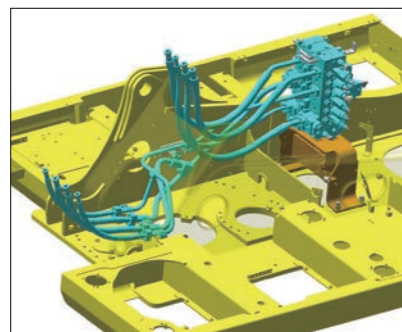

ECO gauge

Equipped with the ECO gauge that can be recognized at a glance on the right of the multi-function color monitor for environment-friendly energy-saving operations. Allows focus on operation in the green range with reduced CO₂ emissions and efficient fuel consumption.



ECO gauge Idling caution

Idling caution

To prevent unnecessary fuel consumption, an idling caution is displayed on the monitor, if the engine idles for 5 minutes or more.

Assists Energy-saving Operations

Auto idle stop function

When the engine has been idling for certain time, the engine stops automatically to reduce unnecessary fuel consumption and exhaust emissions. The duration before the engine shutdown can be easily programmed.



Fuel Saving Support Functions

Just select a working mode that suits your purpose

In P mode, LARGE PRODUCTION is implemented. In E mode, LOW FUEL CONSUMPTION is implemented. E mode can be adjusted widely from E0 to E3 mode, and it adapts flexibly to customer's demands. Komatsu tuned each work mode precisely, ensuring high operability and workability. Just by selecting the work mode, it provides the best performance in demanding applications.

P (Power mode):

Maximum production
Fast cycle time

E (Economy mode):

Better fuel consumption

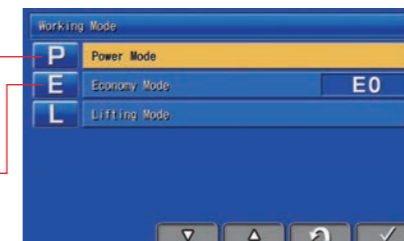

Easy selectable E mode

Compared with the conventional model, E0 to E3 can be easily selected on the monitor.

L Lifting mode:

- Suitable attachment speed
- Lifting capacity is increased 7% by raising hydraulic pressure.

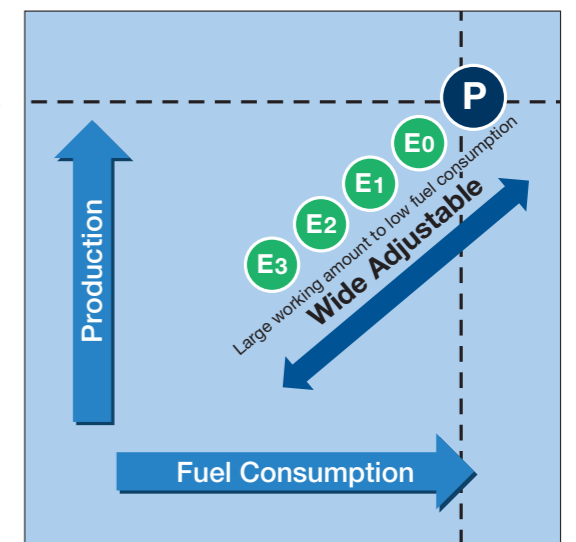

EASY SERVICEABILITY

PC205-10M0



Maintenance is a key element of operating cost. Komatsu focused on reducing maintenance time & cost.

Easy access to filters

Engine oil and fuel system filters are integrated into one side to allow easy maintenance and service.



Easy cleaning cooling unit

Cleanability of the cooling unit has been improved.

- Dust-proof net does not require tools for cleaning
- Single piece Oil cooler, no more space for dust accumulation



Easy oil sampling

Easy oil sampling ports are added. It helps to get oil samples that are agitated properly & helps in accurate analysis.



Minimize breaking of circle grease nipple

The grease nipple of the circle is embedded for protection. It is irrefragible structure even if wood debris or dusts are coiled around a swing circle.



Extended replacement interval of hydraulic oil filter

The replacement interval of the hydraulic oil filter element is extended by 2.5 times. It contributes to reduction of maintenance cost.

2500 h
↑
1000 h



Easy maintenance time management

The monitor informs replacement time of oil and filters on the LCD when the replacement interval is reached.

Maintenance	Interval	Remain
Fuel Prefilter Change	500 h	410 h
Engine Oil Change	500 h	410 h
Engine Oil Filter Change	500 h	410 h
Hyd Oil Tank Breather Change	1000 h	910 h
Fuel Main Filter Change	1000 h	910 h

**Detect abnormality of hydraulic circuit
Clogging sensor for hydraulic oil as standard**

When the hydraulic oil filter is clogged, the caution message pops up on the monitor to notify filter replacement. It helps to take preventive measures to avoid breakdown & repair cost.



Clogging hydraulic oil filter caution

Pre-cleaner for dusty condition (Optional)

Even in dusty places, by installing pre-cleaner coupled with the large air cleaner, the frequency of cleaning the air cleaner will be reduced. Durability has also improved by adopting new high efficiency pre-cleaner.



Battery disconnect switch

A battery disconnect switch allows a technician to disconnect the power supply and lock out before servicing or maintenance of the machine. It also minimize discharge of the battery during non operation for long-term. System operating lamp tells the timing of battery disconnect & prevent controller failures.



Other Features

Easy cleaning drain port of fuel tank

Improved drainability of hydraulic oil and fuel

Easy to check level of hydraulic oil

Blow-by pressure detection

Fuel line contamination prevention

HIGHER DURABILITY

High Strength Work Equipment & Frames to work with large size bucket.
It has Durability to Withstand Demanding Conditions in General Construction Sites.

Enhanced work equipment

Komatsu has built work equipment with increased durability in any application. It is a structure that endures the harsh test and incorporates highly accurate controlled welding technology. Ultrasonic inspection ensures quality.

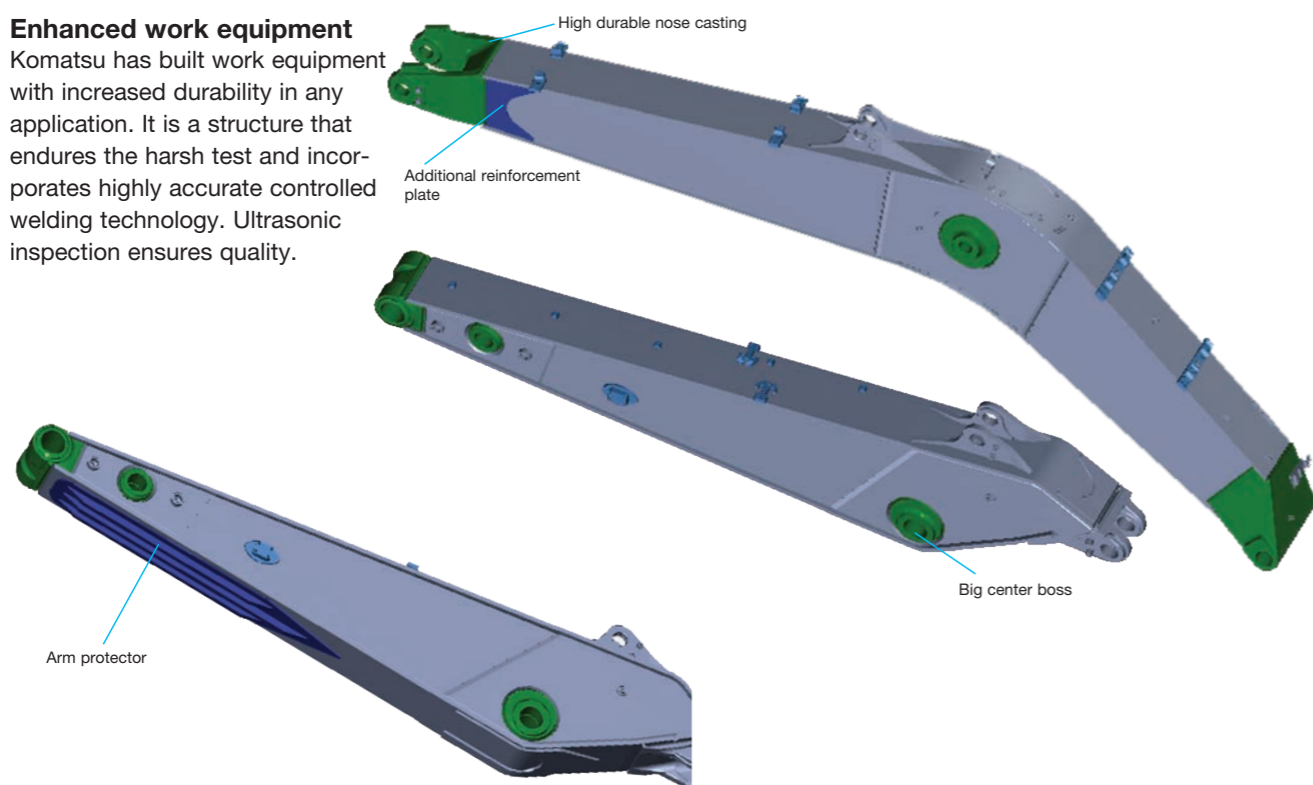

Strengthened swing circle

Swing circle with improved durability supports stable operation in any severe jobsite.

Reliable Komatsu components

All of the major components, such as engine, hydraulic pumps, hydraulic motors and control valves are exclusively designed and manufactured by Komatsu.

Highly reliable electronic devices

Exclusively designed electronic devices have passed severe testing.

- Controllers • Sensors • Connectors
- Heat resistant wiring

Sealed connector

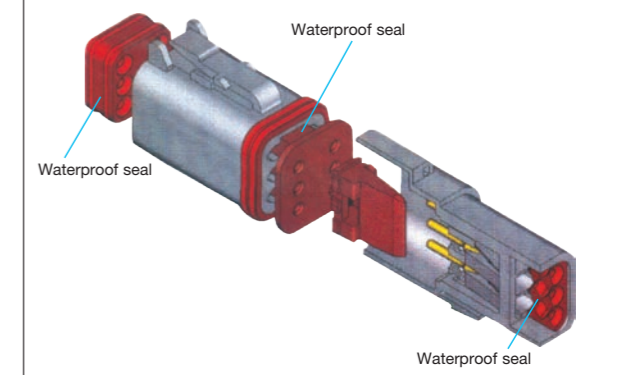

ICT & KOMTRAX

PC205-10M0

LARGE HIGH RESOLUTION LCD MONITOR

Large Multi-lingual High Resolution LCD Monitor
A large user-friendly high resolution LCD color monitor enables safe, accurate and smooth work. Simple and easy to operate switches. Function keys facilitate multi-function operations. Displays data in 15 languages to globally support operators around the world.

Indicators

- 1 Auto-decelerator
- 2 Working mode
- 3 Travel speed
- 4 Engine water temperature gauge
- 5 Hydraulic oil temperature gauge
- 6 Fuel gauge
- 7 ECO gauge
- 8 Fuel consumption gauge
- 9 Function switches menu
- 10 Language select

Basic operation switches

- 1 Auto-decelerator
- 2 Working mode selector
- 3 Traveling selector
- 4 Buzzer cancel
- 5 Wiper
- 6 Window washer

Function switches

Basic operation switches

A/C operation switches

Supports Efficient Operation

The main screen displays advices for promoting energy-saving operations as needed. The operator can use the ECO guidance menu to check the operation records, ECO guidance records, average fuel consumption logs, etc.

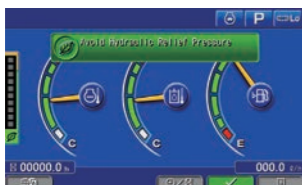

ECO guidance

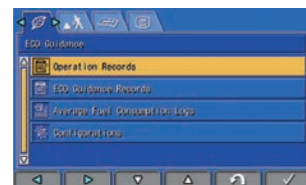

ECO guidance menu

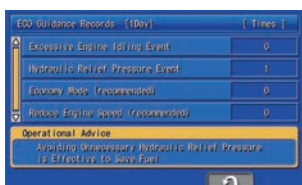

ECO guidance records



Operation records

Equipment Management Monitoring System

Monitor function

Controller monitors engine oil level, coolant temperature, battery charge air clogging, etc. If the controller finds any abnormality, it is displayed on the LCD.

Maintenance function

The monitor informs replacement time of oil and filters on the LCD when the replacement interval is reached.

Trouble data memory function

Monitor stores abnormalities for effective troubleshooting.

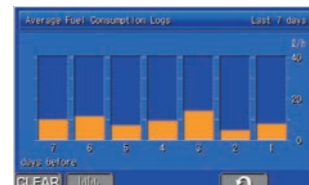

Average fuel consumption logs

KOMTRAX

The Komatsu remote monitoring and management technology provides insightful data about your equipment and fleet in user-friendly format.

Energy Saving Operation Report

KOMTRAX delivers the energy-saving operation report based on the operating information such as fuel consumption, load summary and idling time, which helps you efficiently run a business.

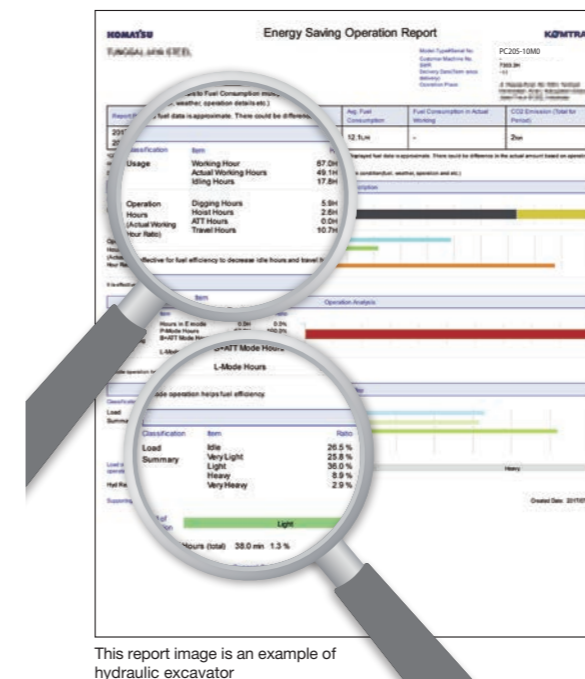

This report image is an example of hydraulic excavator

Equipment Management Support

Through the web application, a variety of search parameters are available to quickly find information about specific machines based on key factors. Moreover, KOMTRAX finds out machines with problems from your fleet and shows you through an optimal interface.



Location

Working status

Periodic maintenance

The report contents and data depend on the machine model.

Optimum Strategy for Efficient Work

With the detailed information that KOMTRAX provides, you can manage your fleet conveniently on the web anytime, anywhere. It gives you the power to make informed decisions and long-term strategy.



SAFETY & COMFORT

PC205-10M0



Gas-assisted damper cylinders for opening engine hood easily & lock bar for safety

Gas-assisted damper cylinders helps opening the engine hood with light force. Lock bar is also equipped. This equipment will support during maintenance and repair.



Thermal guard, fan guard

Preventing direct contact to high temperature parts or the finger being caught by fan when checking around the engine, by installing thermal guards and fan guard.



Rear view monitor system (Optional)

A new rear view monitor system display has a rear view camera image that is continuously displayed together with the gauges and important vehicle information. This enables the operator to carry out work while easily checking the surrounding area. Even if it is on another screen, it changes to the rear camera image at the same time as the any operation lever is operated.



Lock lever

Locks the hydraulic pressure to prevent unintentional movement. Neutral start function allows machine to be started only in lock position.



Large handrail



Pump/Engine room partition

Large side view, rear and sidewise mirrors



Ensuring Operator's Comfort contributes to increased Safety and Productivity.

Suspension seat

Suspension seat with weight adjustment function as standard equipment. This seat can reduce fatigue even in operation for a long time.



Pressurized cab

Pressurizing inside the cab to minimize the dust entering from outside. It keeps the cab clean.

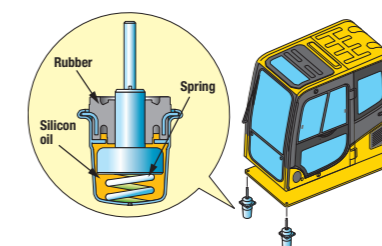

Low cab noise

With substantially low noise, you can comfortably operate for long hours. Ambient noise is also reduced, reducing the stress of workers near the machine.

Automatic A/C

It adjusts automatically to a comfortable temperature throughout the year, even in hot and cold areas.

Low vibration with cab damper mounting

The cab damper mounting combined with high rigidity deck aids in vibration reduction at operator seat.

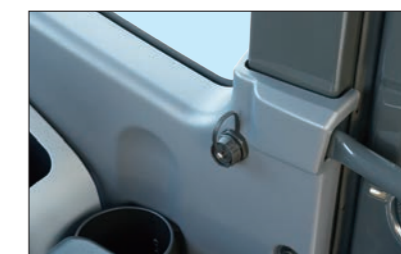

The location may change

12 V power supply (Optional)

Magazine box

Cool & hot box

Luggage box



PRODUCT SUPPORT

SPECIFICATION

PC205-10M0



Komatsu Total Support

To keep your machine available and minimize operation costs, L&T CMB (Komatsu Distributor) provides total equipment support before and after procuring the machine.

Fleet recommendation

L&T CMB will study the customer jobsite and provide the most optimum fleet recommendation with detailed information to meet your application needs when you are considering to buy new machines or to replace the existing ones.

Technical support

L&T CMB offers effective services for maintenance and support of Komatsu machine.

- Preventive Maintenance (PM) clinic
- Oil & Wear analysis program
- Undercarriage inspection service
- Hose inspection

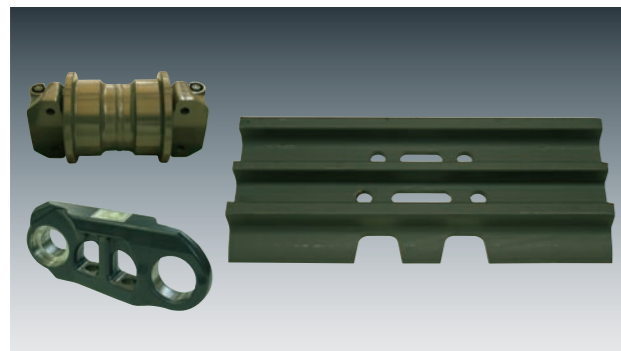

Product support

Komatsu machines are supported by L&T CMB's strong nationwide network of dealerships, parts outlets and service centres.

Parts availability

L&T CMB with its central warehouse at Nagpur and nationwide network of dealership ensure ready availability and highest first pick rate of genuine and quality guaranteed Komatsu parts.

Repair & maintenance service

L&T CMB offers periodical maintenance and quality repair service to the customers, utilizing and promoting Komatsu programs.



ENGINE

Model Komatsu SAA4D107E-1
 Type Water-cooled, 4-cycle, direct injection
 Aspiration Turbocharged, aftercooled
 Number of cylinders 4
 Bore 107 mm
 Stroke 124 mm
 Piston displacement 4.46 L
 Horsepower:
 SAE J1995 Gross 110 kW 148 HP
 ISO 9249 / SAE J1349 Net 103 kW 138 HP
 Rated rpm 2000 min⁻¹
 Fan drive method for radiator cooling Mechanical
 Governor All-speed control, electronic
 EU Stage 3A emission equivalent.



HYDRAULICS

Type HydrauMind (Hydraulic Mechanical Intelligence New Design) system, closed-center system with load sensing valves and pressure compensated valves
 Number of selectable working modes 6
 Main pump:
 Type Variable displacement piston type
 Pumps for Boom, arm, bucket, swing, and travel circuits
 Maximum flow 439 L/min
 Supply for control circuit Self-reducing valve
 Hydraulic motors:
 Travel 2 x axial piston motor with parking brake
 Swing 1 x axial piston motor with swing holding brake
 Relief valve setting:
 Implement circuits 37.3 MPa 380 kgf/cm²
 Travel circuit 37.3 MPa 380 kgf/cm²
 Swing circuit 28.9 MPa 295 kgf/cm²
 Pilot circuit 3.2 MPa 33 kgf/cm²
 Hydraulic cylinders:
 (Number of cylinders – bore x stroke x rod diameter)
 Boom 2–120 mm x 1334 mm x 85 mm
 Arm 1–135 mm x 1490 mm x 95 mm
 Bucket 1–115 mm x 1120 mm x 80 mm



COOLANT AND LUBRICANT CAPACITY (REFILLING)

Fuel tank (Specified capacity) 400 L
 Coolant 15.5 L
 Engine 18.0 L
 Final drive (Each side) 3.3 L
 Swing drive 5.3 L
 Hydraulic tank 135 L

Choice of Buckets

Category	Capacity (m ³)	Width (mm)		Weight* (kg)	Tooth Quantity	Boom + Arm (m)	
		Without Side Shrouds, Side Cutters	With Side Shrouds, Side Cutters			Standard Undercarriage (600mm Shoes)	Standard Undercarriage (600mm Shoes)
						5.7+2.4	5.7+2.9
General Purpose	0.85	1130	1235	785	5	○	○
	1.0	1165	1270	785	5	□	□

* With side cutters ○ : Density upto 1.8t/m³ □ : Density upto 1.5t/m³



SWING SYSTEM

Drive method Hydrostatic
 Swing reduction Planetary gear
 Swing circle lubrication Grease-bathed
 Service brake Hydraulic lock
 Holding brake/Swing lock Mechanical disc brake
 Swing speed 11.5 min⁻¹



UNDERCARRIAGE

Center frame X-frame
 Track frame Box-section
 Seal of track Sealed track
 Track adjuster Hydraulic
 Number of shoes (Each side) 45
 Number of carrier rollers 2 each side
 Number of track rollers (Each side) 7



DRIVES AND BRAKES

Steering control Two levers with pedals
 Drive method Hydrostatic
 Maximum drawbar pull 178 kN 18200 kgf
 Gradeability 70%, 35°
 Maximum travel speed: High 4.9 km/h (Auto-shift)
 Mid 4.1 km/h (Auto-shift)
 Low 3.0 km/h (Auto-shift)
 Service brake Hydraulic lock
 Parking brake Mechanical disc brake



OPERATING WEIGHT (APPROXIMATE)

Operating weight including 5700 mm one-piece boom, 2400 mm arm, 0.85cum General Purpose backhoe bucket, rated capacity of lubricants, coolant, full fuel tank, operator, and standard equipment.

Shoes	Operating Weight	Ground Pressure
600 mm	20300 kg	46.1 kPa 0.47 kgf/cm ²
800 mm	20900 kg	36.3 kPa 0.37 kgf/cm ²



DIMENSIONS

Arm Length		2410mm	2925 mm
A	Overall length	9830mm	9485 mm
B	Length on ground (Transport)	5700mm	4815 mm
C	Overall height (To top of boom)	3190mm	3005 mm
D	Overall width		2800 mm
E	Overall height (To top of cab)		3040 mm
F	Ground clearance, counterweight		1085 mm
G	Ground clearance (Minimum)		440 mm
H	Tail swing radius		2835 mm
I	Track length on ground		3275 mm
J	Track length		4070 mm
K	Track gauge		2200 mm
L	Width of crawler		2800 mm
M	Shoe width		600 mm
N	Grouser height		26 mm
O	Machine cab height		2095 mm
P	Machine cab width		2710 mm
Q	Distance, swing center to rear end		2795 mm

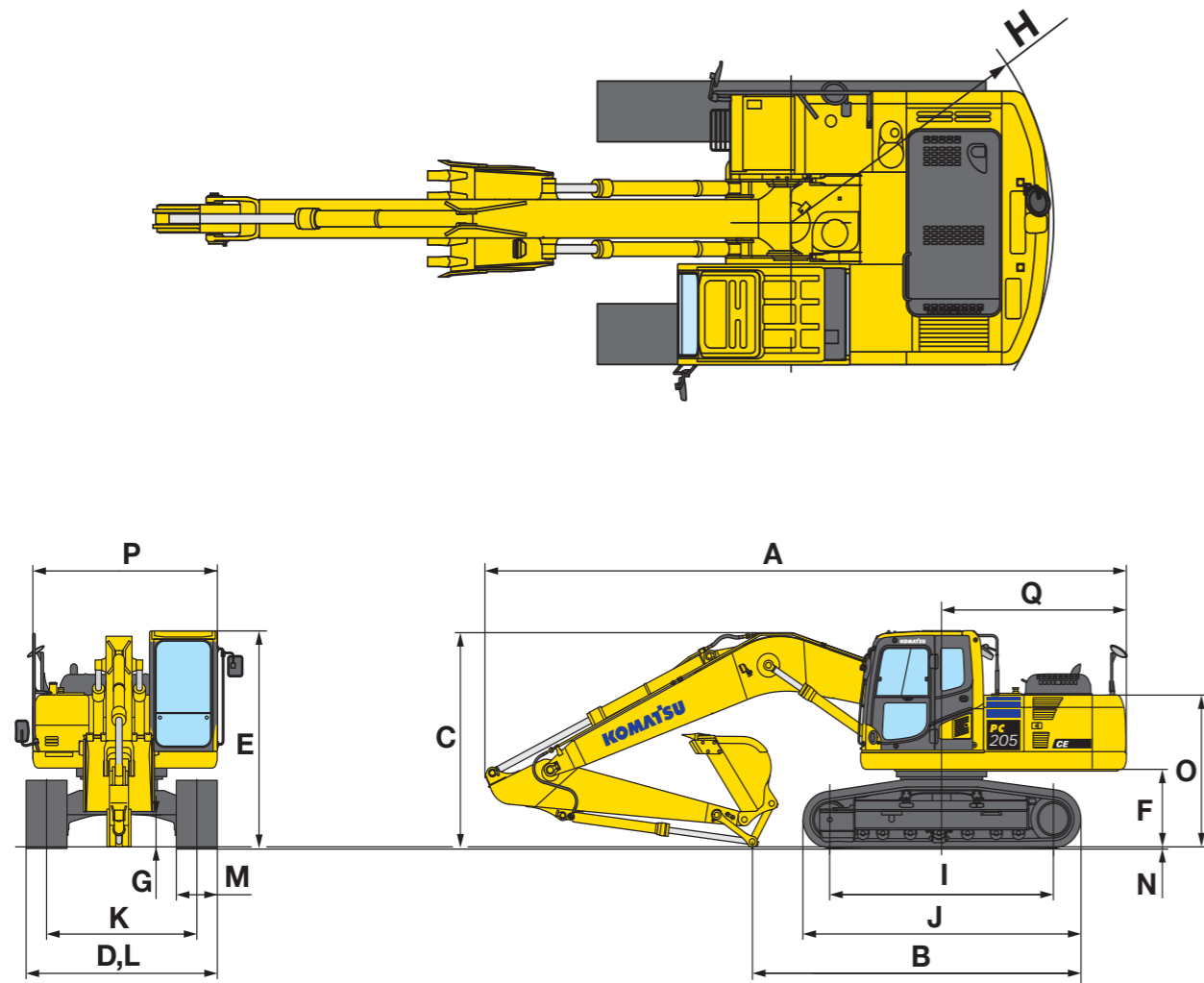

WORKING RANGE

Arm Length		2410mm	2925 mm
A	Max. digging height	9795mm	10000 mm
B	Max. dumping height	6960mm	7110 mm
C	Max. digging depth	6000mm	6620 mm
D	Max. vertical wall digging depth	5080mm	5980 mm
E	Max. digging reach	9390mm	9875 mm
F	Max. digging reach at ground level	9195mm	9700 mm
G	Min. swing radius	3080mm	3040 mm
SAE J 1179 Rating	Bucket digging force at power max.	138 kN 14100 kgf	138 kN 14100 kgf
	Arm crowd force at power max.	124 kN 12600 kgf	101 kN 10300 kgf
ISO 6015 Rating	Bucket digging force at power max.	149 kN 15200 kgf	149 kN 15200 kgf
	Arm crowd force at power max.	127 kN 13000 kgf	108 kN 11000 kgf

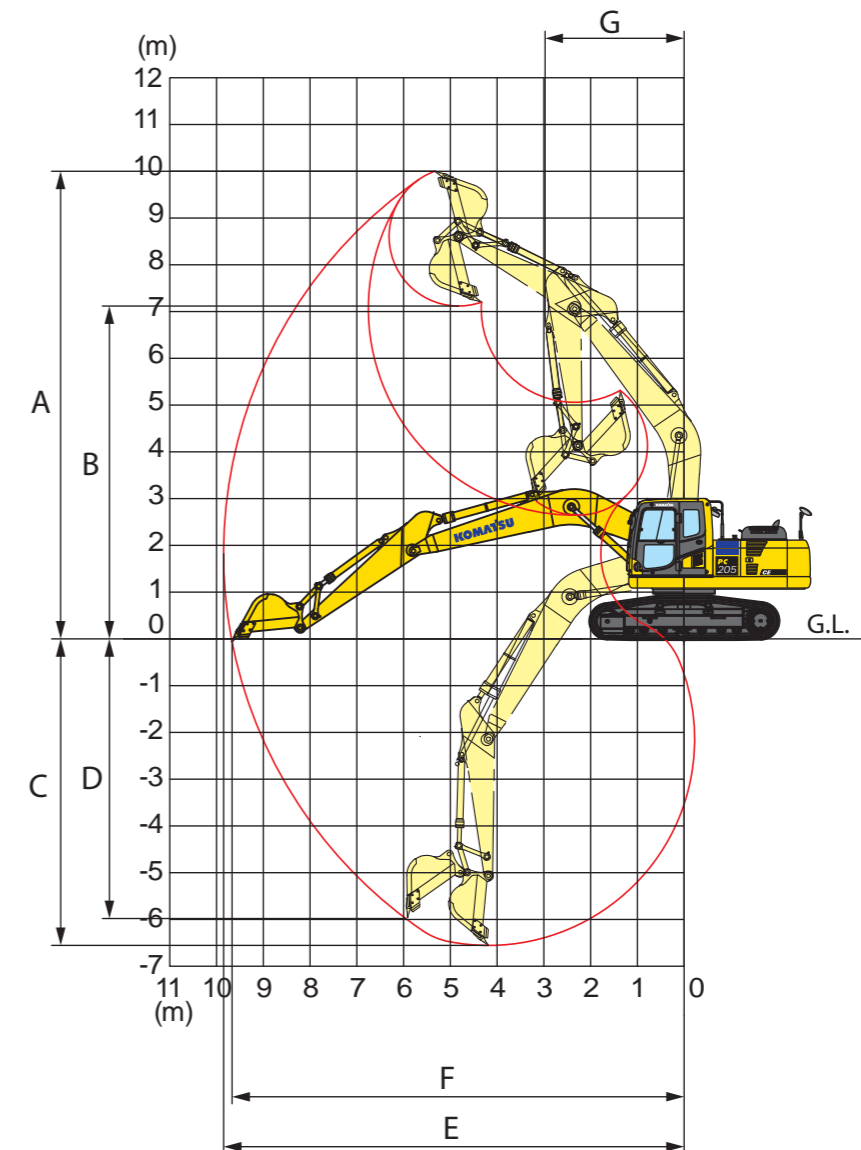



LIFTING CAPACITY WITH LIFTING MODE

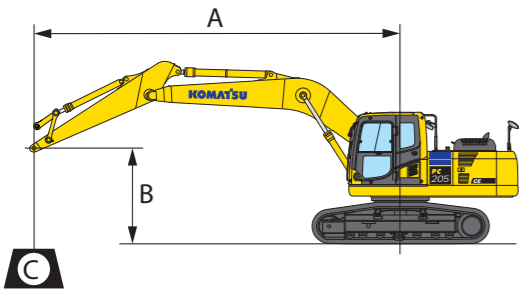

A: Reach from swing center
 B: Arm top pin height
 C: Lifting capacity
 Cf: Rating over front
 Cs: Rating over side
 ⊗: Rating at maximum reach

Conditions:
 • 5700 mm one-piece boom

PC205-10M0		Arm: 2412 mm		Without bucket		Shoe: 600 mm triple grouser							
B	A	MAX	7.5 m		6.0 m		4.5 m		3.0 m		1.5 m		
			Cf	Cs	Cf	Cs	Cf	Cs	Cf	Cs	Cf	Cs	
7.5 m	5.49 m	*5400 kg	*5050 kg										
6.0 m	6.71m	*5050 kg	3600 kg			*5250 kg	4400 kg	5500	5500				
4.5 m	7.44m	*4350 kg	2950 kg			*5700 kg	4250 kg	*6700 kg	*6600 kg	*9300 kg	*9300 kg		
3.0 m	7.81 m	*3900 kg	2650 kg	4200 kg	2850 kg	5900 kg	4000 kg	*8450 kg	6050 kg				
1.5 m	7.89 m	3750 kg	2550 kg	4050 kg	2750 kg	5650 kg	3750 kg	8800 kg	5600 kg				
0 m	7.67 m	3900 kg	2600 kg	4000 kg	2650 kg	5500 kg	3650 kg	8550 kg	5400 kg				
-1.5 m	7.13 m	4300 kg	2850 kg			5450 kg	3600 kg	8500 kg	5350 kg	*11350 kg	10300 kg		
-3.0 m	6.19 m	5350 kg	3550 kg			5550 kg	3650 kg	8650 kg	5450 kg	*12950 kg	10500 kg		
-4.5 m													

PC205-10M0		Arm: 2925 mm		Without bucket		Shoe: 600 mm triple grouser							
B	A	MAX	7.5 m		6.0 m		4.5 m		3.0 m		1.5 m		
			Cf	Cs	Cf	Cs	Cf	Cs	Cf	Cs	Cf	Cs	
7.5 m	6.42 m	*3340 kg	*3340 kg			*4520 kg	*4520 kg						
6.0 m	7.49 m	*3190 kg	3080 kg	*3560 kg	3090 kg	*4750 kg	4560 kg						
4.5 m	8.15 m	*3190 kg	2600 kg	4470 kg	3030 kg	*5390 kg	4370 kg	*6010 kg	*6010 kg				
3.0 m	8.49 m	*3330 kg	2350 kg	4340 kg	2900 kg	6130 kg	4090 kg	*8210 kg	6290 kg	*12010 kg	11810 kg		
1.5 m	8.56 m	3410 kg	2240 kg	4180 kg	2760 kg	5840 kg	3820 kg	9110 kg	5730 kg	*7340 kg	*7340 kg		
0 m	8.36 m	3470 kg	2260 kg	4060 kg	2650 kg	5610 kg	3610 kg	8700 kg	5380 kg	*5880 kg	*5880 kg		
-1.5 m	7.87 m	3740 kg	2430 kg	4010 kg	2600 kg	5510 kg	3520 kg	8560 kg	5260 kg	*10000 kg	9920 kg	*5870 kg	
-3.0 m	7.03 m	4410 kg	2850 kg			5530 kg	3540 kg	8640 kg	5320 kg	*15560 kg	10260 kg	*10420 kg	
-4.5 m	5.68 m	6120 kg	3930 kg					8870 kg	5520 kg	*13360 kg	10620 kg		

* Load is limited by hydraulic capacity rather than tipping. Ratings are based on ISO standard No.10567. Rated loads do not exceed 87% of hydraulic lift capacity or 75% of tipping load.



STANDARD EQUIPMENT

ENGINE

- Automatic engine warm-up system
- B20 Bio diesel Compliant
- Coolant filter
- Dry type air cleaner, double element
- Engine, Komatsu SAA4D107E-1
- Engine overheat prevention system
- Auto idle shutdown
- Radiator and oil cooler dust proof net

ELECTRICAL SYSTEM

- Alternator, 24 V/35 A, brushless
- Auto-decelerator
- Batteries, 2 X 12 V/88 Ah
- Battery disconnect switch with operation lamp
- Starting motor, 24 V/4.5 kW
- Working light, 4 (Boom and RH cab)

HYDRAULIC SYSTEM

- Boom holding valve
- Clogging sensor for hydraulic oil return filter
- Power maximizing system
- Pressure Proportional Control (PPC) hydraulic control system
- Working mode selection system

GUARDS AND COVERS

- Fan guard structure

UNDERCARRIAGE

- Hydraulic track adjusters (Each side)
- Track guiding guard, center section
- Track roller, 7 each side
- Shoe, 600 mm triple grouser

OPERATOR ENVIRONMENT

- Automatic A/C with defroster
- Equipment Management Monitoring System
- Large high resolution LCD monitor
- Rear view mirrors (RH, LH)
- Suspension seat

OTHER EQUIPMENT

- Blow-by sensor
- Counterweight
- Electric horn
- KOMTRAX
- Oil sampling port (Engine & hydraulic)
- Rear reflector



OPTIONAL EQUIPMENT

ENGINE

- Air pre-cleaner

ELECTRICAL SYSTEM

- Amber beacon lamp on cab roof
- Working lights
 - 1 on counterweight
 - 1 between Boom Cylinders

GUARDS AND COVERS

- Revolving frame undercover

UNDERCARRIAGE

- Triple Grouser Shoes
- 800mm track

OPERATOR ENVIRONMENT

- 12 V power supply
- Cigar Lighter, Ashtray, Radio
- Rear view monitor system

SERVICING EQUIPMENT

- Preventive Maintenance (PM) service connector

Standard/option equipment may change. For more details, please consult your distributor.